

C:\Documents and Settings\owner\My Documents\0012\UG\5343 Watford\Drawings\Layout-3.dwg, 13/04/2013 19:47:00

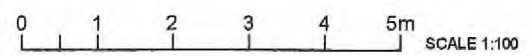
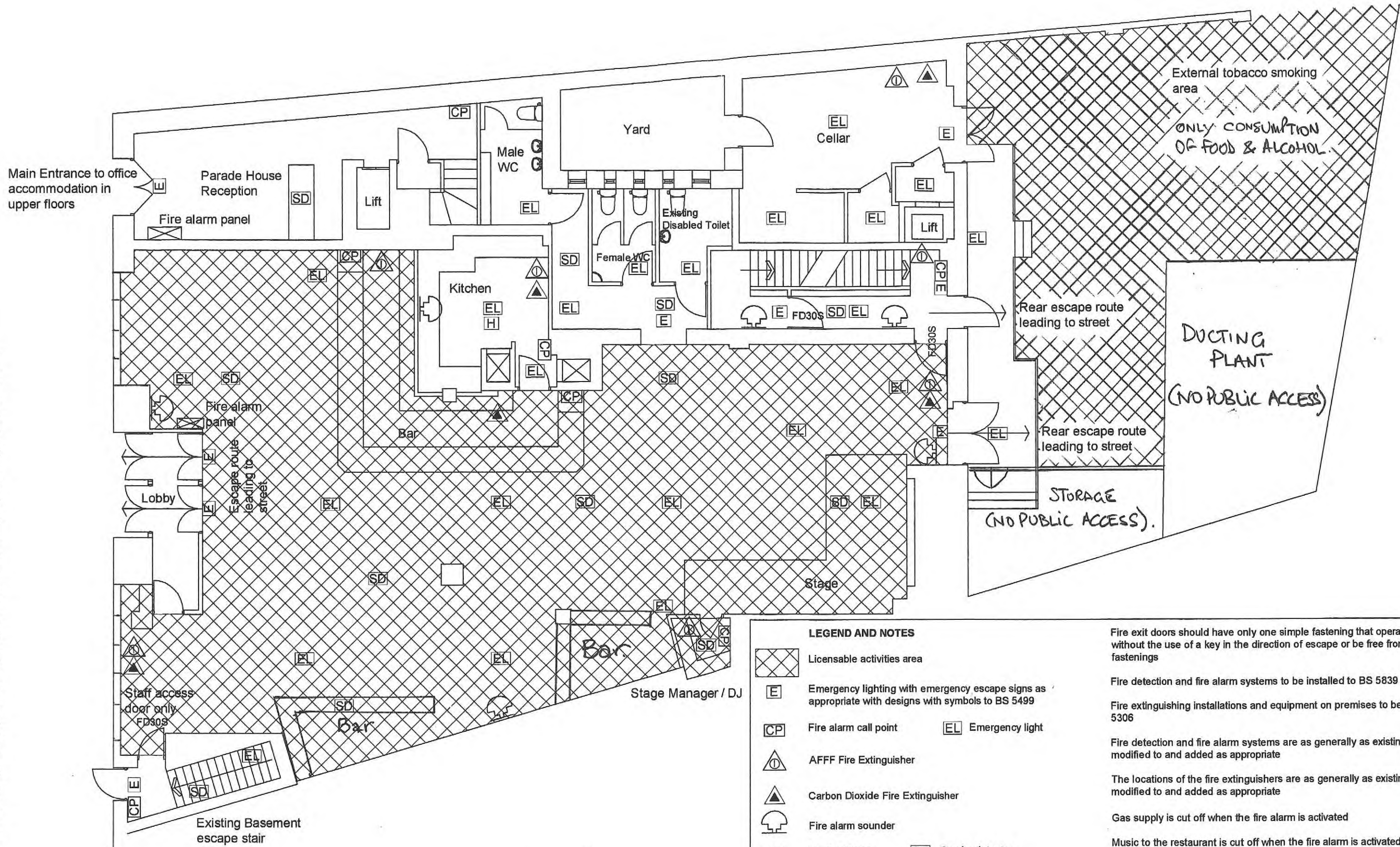

**LEGEND AND NOTES**

- Licensable activities area
- Emergency lighting with emergency escape signs as appropriate with designs with symbols to BS 5499
- Fire alarm call point
- AFFF Fire Extinguisher
- Carbon Dioxide Fire Extinguisher
- Fire alarm sounder
- Heat detector
- Smoke detector
- Emergency light
- Denotes FD30S fire door to BS 476: part 22, to be fitted with fully compliant BS EN 1154 self closing device and using 3 no. 25 x 45mm hinges glued and screwed to frame. Door assembly to be fitted with smoke seals and intumescent fire seals which have a BBA certificate

Fire exit doors should have only one simple fastening that operates without the use of a key in the direction of escape or be free from all fastenings

Fire detection and fire alarm systems to be installed to BS 5839

Fire extinguishing installations and equipment on premises to be as BS 5306

Fire detection and fire alarm systems are as generally as existing but are modified to and added as appropriate

The locations of the fire extinguishers are as generally as existing but are modified to and added as appropriate

Gas supply is cut off when the fire alarm is activated

Music to the restaurant is cut off when the fire alarm is activated

The night club's fire alarm is to be linked to the office space above and the basement accommodation

This drawing is subject to a Building Control application and Licensing application to Watford Council and is not issued for construction

Read this drawing with Basement Plan 5343/02.

Some fire fighting equipment, emergency lighting and fire exit signs are already installed